



BREATHABLE MEMBRANES

For Sloped Roofs & Rain Screen Wall Systems

AirOutshield ROOF

AirOutshield WALL

AirOutshield UV

The Need

The most significant factor in building durability is the control of moisture accumulation in the wall and roof assembly. Each year the North American building industry spends billions of dollars in litigation and repair related to moisture intrusion in buildings. Moisture intrusion can result in reduced insulation performance, interior deterioration, mould and structural damage.

Function

SRP breathable membranes are multi layer, spun bonded materials that control moisture intrusion and accumulation in the assembly by keeping external water out while allowing water vapour to escape.

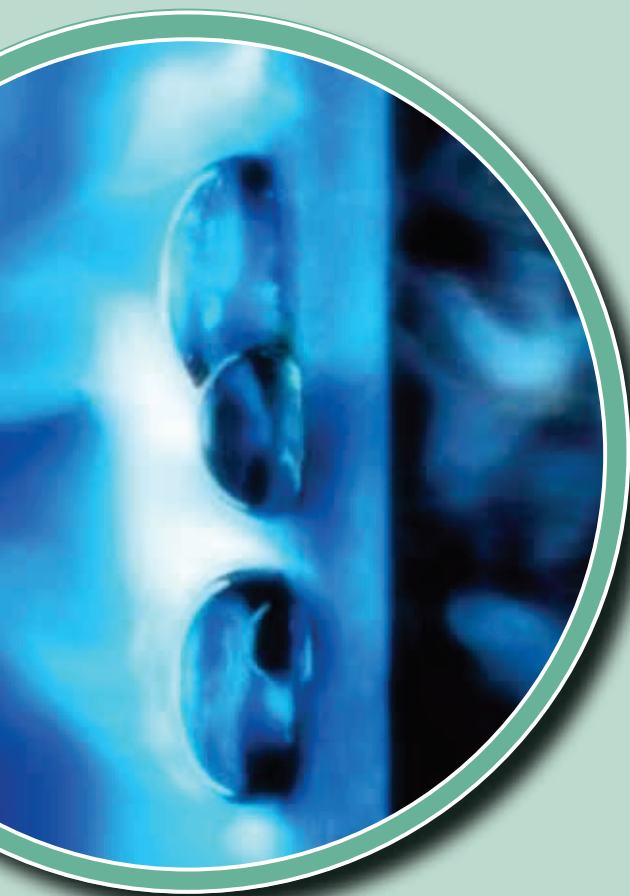

SRP membranes resist water and allow moisture laden air to pass.



Microscopic cross section showing 3 distinct layers.

Why choose SRP Membranes?

- **Superior Moisture Vapour Transmission Rate (MVTR):** With a MVTR of 60 to 160 perms; SRP membranes enable substrates and assemblies to dry significantly faster than lower perm “breather” membranes, and reduce potential for deterioration and mould.
- **Water Resistance:** Water that penetrates the primary cladding or roofing contacts the SRP membrane and is directed away from the assembly.
- **Air Barrier:** SRP Canada AirOutshield membranes comply with the requirements of the National Building Code of Canada (NBCC) requirements for “Air Barrier Materials.” See installation guide for details.
- **Durable:** Tear and puncture resistance reduces repairs and labour costs when exposed to wind or foot traffic.
- **Self-Cinching:** Seals around fasteners minimizing the need for sealants.
- **High Temperature Resistance:** Polypropylene (PP) composition provides superior resistance to high temperatures.
- **UV Resistant:** SRP membranes can be left in place and exposed to UV longer than other membranes and are available in a version with long term UV resistance for open jointed systems.
- **Lightweight:** SRP products are substantially lighter and easier to handle than asphalt based membranes.
- **Slip Resistant:** The textured finish on our roofing products is more slip resistant than other membranes.
- **Versatile:** SRP breathable membranes can be installed behind all types of wall cladding systems and sloped roofs.
- **Systems Approach:** SRP membranes are part of a complete system including compatible tapes and accessories.

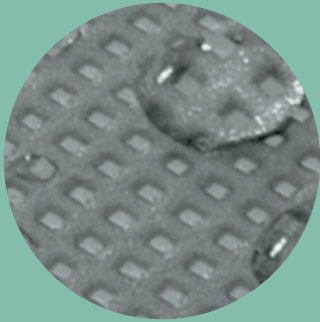

SRP AirOutshield ROOF

A secondary drainage plane and air barrier under roofing systems including; metal, copper, zinc, slate, cedar, clay tile and other systems that require an underlayment.

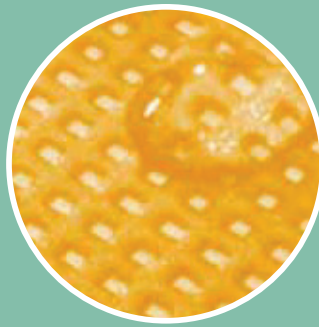

SRP AirOutshield WALL

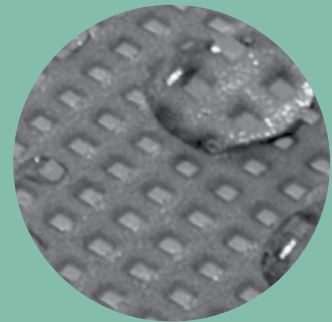

A secondary drainage plane and air barrier behind rainscreen wall cladding systems; brick, siding (wood fibre cement, metal), shingles (metal, copper, zinc, cedar). Installed in open joint cladding systems including Eternit, Superpanel, Trespa Meteon, Prodema. Black available.



SRP AirOutshield UV

This weather resistant barrier (WRB) provides a high level of breathability and long term UV resistance. It is designed specifically for use with open jointed rain screen cladding systems including slotted wood siding, panel systems, and other “open joint” systems where resistance to UV exposure is needed.

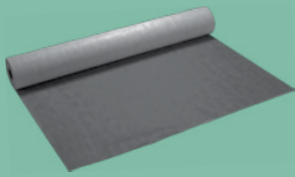
SELECTION CHART

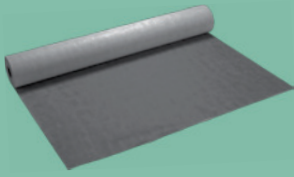
	SRP AirOutshield ROOF	SRP AirOutshield WALL	SRP AirOutshield UV
Product/Function			
Sloped Roofing	●		
Walls	●	●	●
Drainage Plane	●	●	●
Air Barrier	●	●	
Colour	Black	Orange or Black	Black
Roll Size	1.5m x 50m (59 in x 164 ft)	1.5m x 50m (59 in x 164 ft)	1.5m x 50m (59 in x 164 ft)

SLOPED ROOF APPLICATIONS



- Steel, Zinc, or Copper Roofing
- Ventilation Mat (Optional)
- SRP AirOutshield ROOF
- Insulation
- Vapour Barrier
- Metal or Plywood Deck

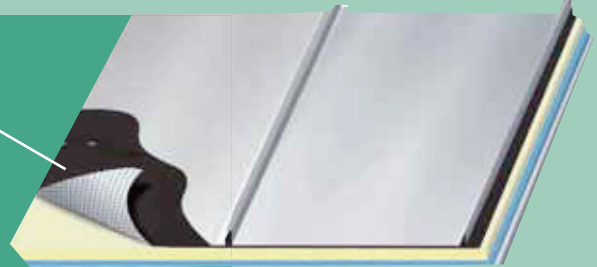

- Slate Roof
- Ventilation Mat (Optional)
- SRP AirOutshield ROOF
- Sheathing
- Insulation
- Vapour Barrier



- Clay or Concrete Tile
- Ventilation Mat (Optional)
- SRP AirOutshield ROOF
- Sheathing
- Insulation
- Vapour Barrier

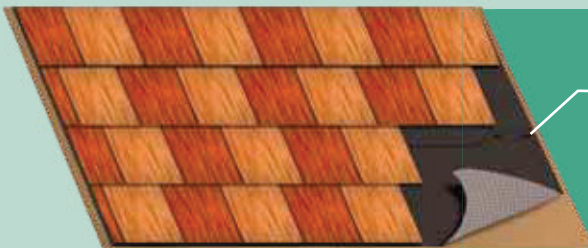

- Cedar Roofing
- Ventilation Mat
- SRP AirOutshield ROOF
- Sheathing
- Insulation
- Vapour Barrier



WALL APPLICATIONS

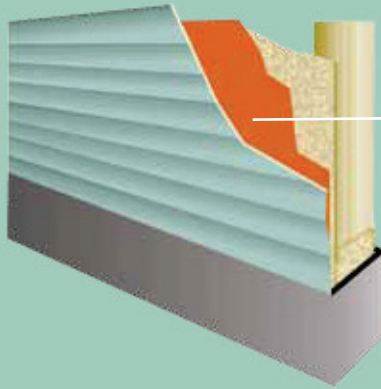
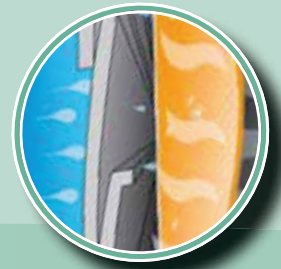

- Siding; Cement Board, Vinyl, Aluminum, Wood Composite
- Ventilation Mat (Optional)
- SRP AirOutshield WALL
- Exterior Sheathing and/ or Insulation
- Vapour Barrier



- Metal Cladding; Zinc, ACM (Aluminum Composite Material) Copper, Steel
- Ventilation Mat (Optional)
- SRP AirOutshield WALL
- Exterior Sheathing and/ or Insulation
- Vapour Barrier

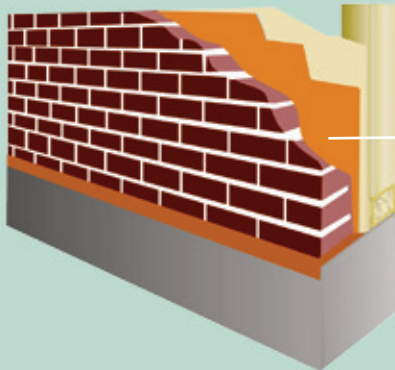
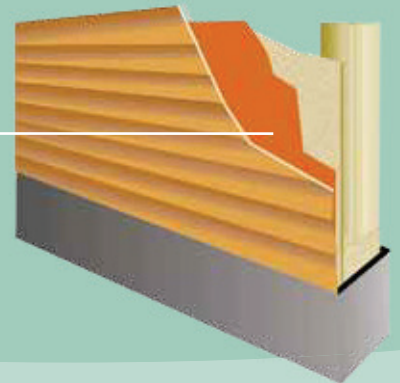

- Masonry; Brick, Stone or Masonry Veneer
- Ventilation Mat or Air Space
- SRP AirOutshield WALL
- Exterior Sheathing and/ or Insulation
- Vapour Barrier



- Open Jointed, Ventilated Rain Screen cladding Systems
- Cement Board, HPL Panels, Wood Slats and other Open Jointed Systems
- Ventilation Mat or Air Space
- SRP AirOutshield UV (Black)
- Exterior Sheathing and/ or Insulation
- Vapour Barrier

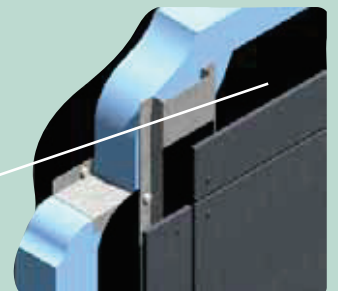

ACCESSORIES



SRP 2" SEAMSEAL

Roll Size: 50mm x 15.24m
(2" x 50')
Colour: Gray



SRP 4" DETAIL TAPE

Roll Size: 100mm x 15.24m
(4" x 50')
Colour: Gray



SRP D.S. TAPE DOUBLE SIDED TAPE

Roll Size: 25mm x 15.24m
(1" x 50')
Colour: Gray

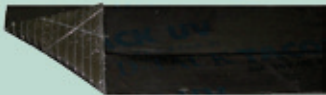

SRP 60 UV Seamseal UV RESISTANT

Roll Size: 60mm x 25m
(2.4" x 81')
Colour: Black

Wood Framed Siding in Multi Residential



Metal Roofing



Copper Roofing



Cedar Shingles with
Ventilation Mat

Open Joint Rainscreen Panel System



RESOURCES

The following items can
be sourced from our website:

www.srpcanada.ca

Technical Data Sheets
Installation Guides
Guide Specifications
Detail Drawings